



**Washington County Circuit Court
Land Survey, Subdivision, and Condominium Plats
MSA C2167: (Plats)
Index by Reference**

Reference: Plat 3371
Date: 1991/03/15
Description: Washington County Sanitary Subdistrict 19-1, Sandy Hook (Sewer), Revision
Storage Location: WH
Image(s): *Microfilm Scan(s):*
[MSA C2167-67, p. 1](#) From SL 21,164 (File Size: 145 kb)

Note: If images prove unsatisfactory or there are errors in this citation, please [send this page](#) to Geographical Services. Every effort is being made by the Maryland State Archives to improve the archival quality of plat images and citations. Your help in making this possible is appreciated.

| [Home](#) | [Search](#) | [All Maryland Counties](#) | [Maryland Judiciary](#) | [Washington County Records](#) | [Maryland State Archives](#) |

An Archives of Maryland electronic publication
© Copyright June 25, 2008, Maryland State Archives

Maryland State Archives

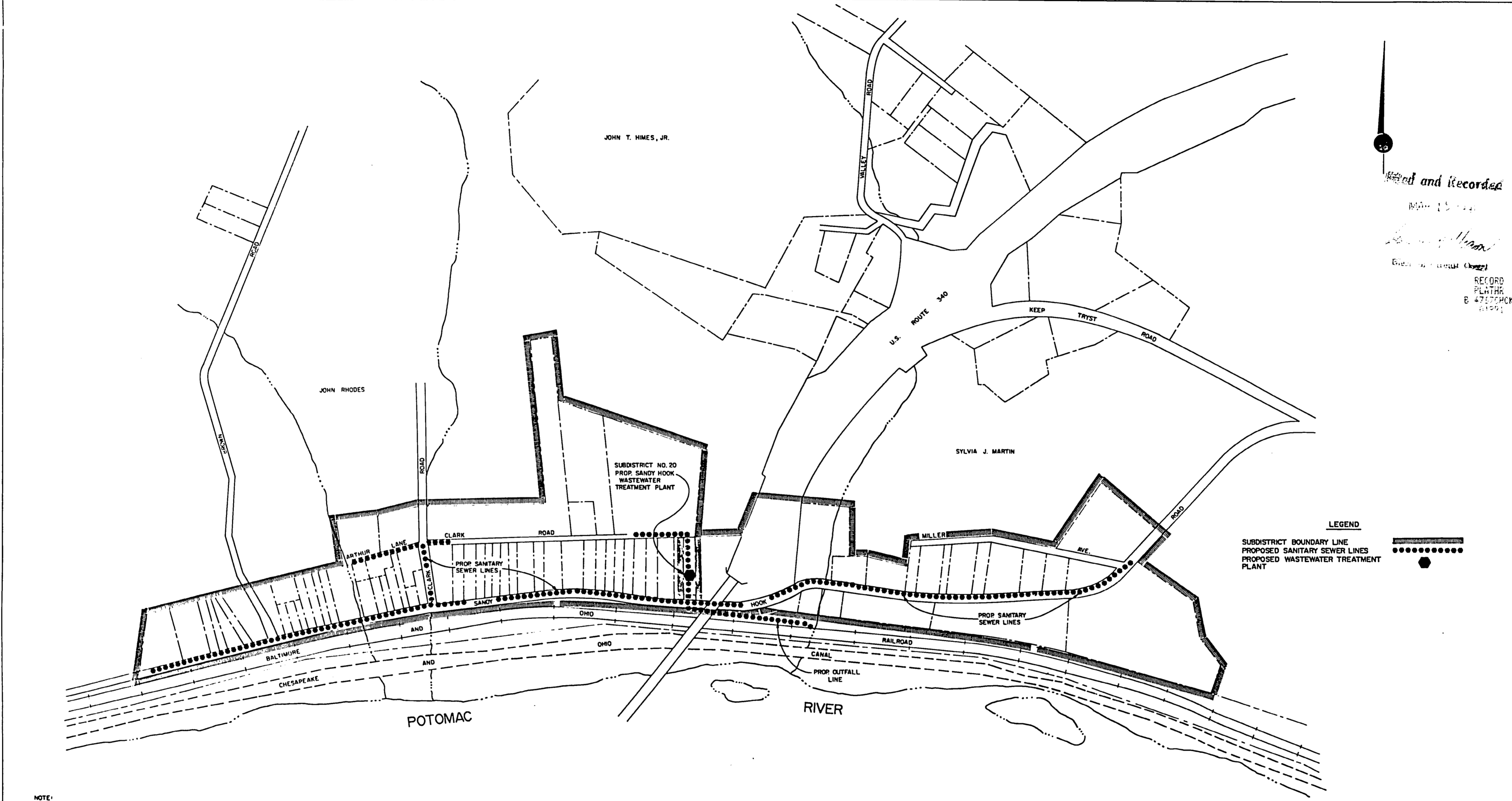

Filed and Recorded
 MAR 15 1990
 [Signature]
 Recorder
 RECORD 2.50
 PLATING 2.50
 B 47507CHK 5.00
 15 P4:14

NOTE:
 THIS PLAT SUPERCEDES THE PLAT OF SUBDISTRICT NO. 19
 TITLED SANDY HOOK SEWER, DATED JULY 1988, DWG. NO.
 5019-001, RECORDED IN PLAT FOLIO 2538 AMONG THE
 PLAT OF RECORDS OF WASHINGTON COUNTY, MARYLAND.

APPROVED BY:
 WASHINGTON COUNTY SANITARY DISTRICT
James G. Johnson 9/24/90 *R. Marshall Johnson* 9/24/90
 CHAIRMAN DATE SECRETARY TREASURER DATE

APPROVED BY:
 BOARD OF COUNTY COMMISSIONERS OF WASHINGTON COUNTY
Ronald Johnson DATE *Joi L. Bittner* 10/20/90
 PRESIDENT DATE CLERK DATE

BASE MAPS FURNISHED BY THE
 PROPERTY MAP DIVISION OF THE
 MARYLAND DEPARTMENT OF
 ASSESSMENTS AND TAXATION.

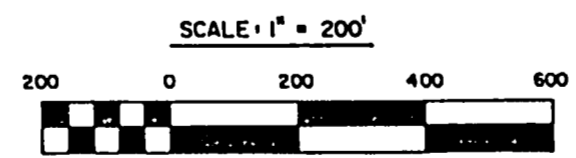

PLAT NO. 3371
 FILE NO. 3851

WASHINGTON COUNTY SANITARY DISTRICT WASHINGTON COUNTY, MD.			
REVISED PLAT OF SUBDISTRICT NO. 19 (SEWER) SANDY HOOK			
DATE 7-16-90	DRAWN BY S.F.E.	PLAT NO. P-190-1000	SHEET NO. 1 OF 1

MSA [Redacted]
 CSU 2167-67



Washington County Circuit Court
Land Survey, Subdivision, and Condominium Plats
MSA C2167: (Plats)
Index by Reference

Reference: Plat 3372
Date: 1991/03/15
Description: Washington County Sanitary Subdistrict 19-1, Sandy Hook (Water), Revision
Storage Location: WH
Image(s): *Microfilm Scan(s):*
[MSA C2167-68, p. 1](#) From SL 21,164 (File Size: 146 kb)

Note: If images prove unsatisfactory or there are errors in this citation, please [send this page](#) to Geographical Services. Every effort is being made by the Maryland State Archives to improve the archival quality of plat images and citations. Your help in making this possible is appreciated.

| [Home](#) | [Search](#) | [All Maryland Counties](#) | [Maryland Judiciary](#) | [Washington County Records](#) | [Maryland State Archives](#) |

An Archives of Maryland electronic publication
© Copyright June 25, 2008, Maryland State Archives

Maryland State Archives

RECORD 2.50
 PLATHR 2.50
 P 4769CHCK 5.00
 01991 3 15 P4-16

WASH. CO. PLAT NO. **3372**
 WASH. CT REC. NO. **3852**

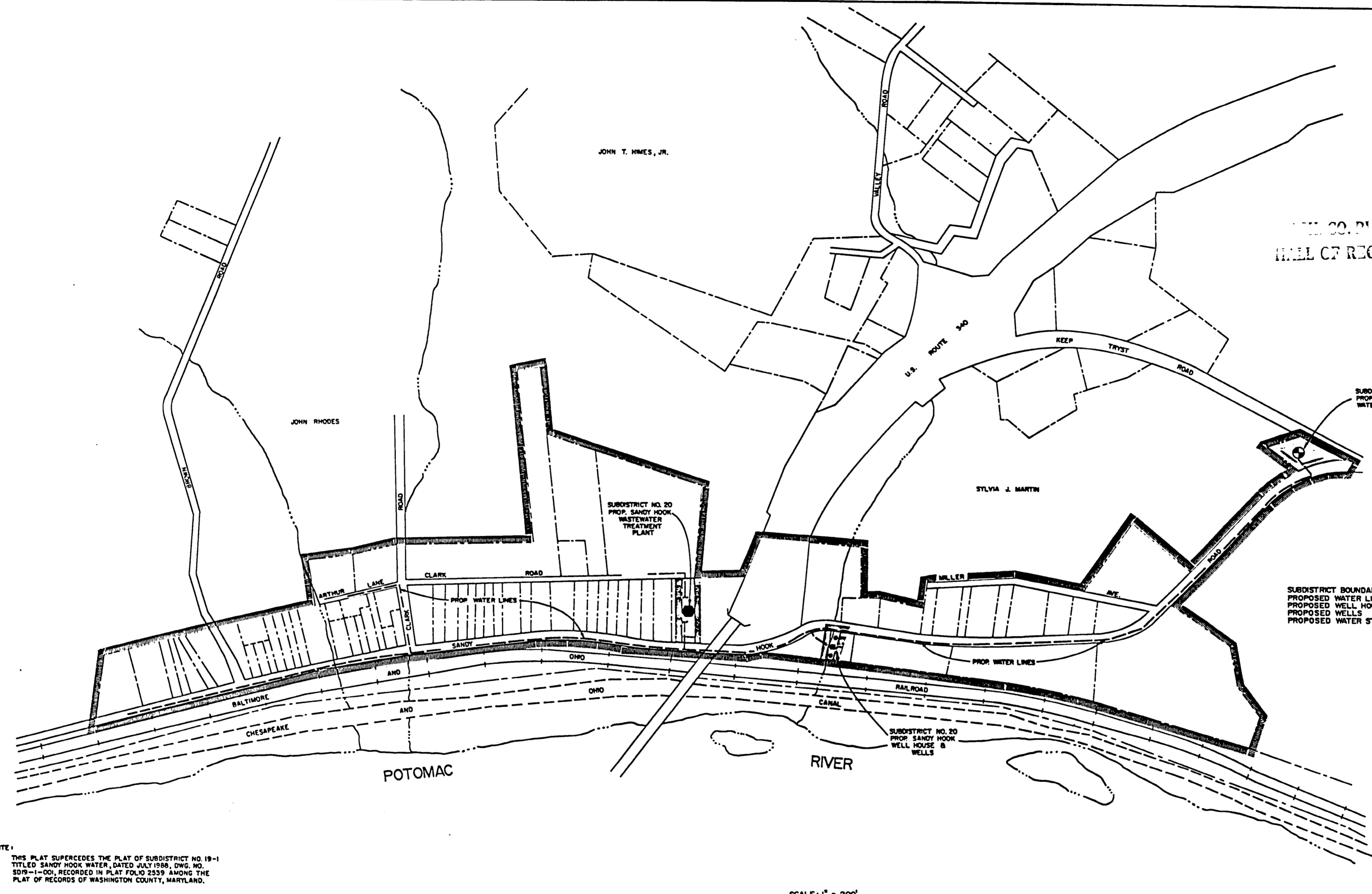

LEGEND
 SUBDISTRICT BOUNDARY LINE
 PROPOSED WATER LINES
 PROPOSED WELL HOUSE
 PROPOSED WELLS
 PROPOSED WATER STORAGE TANK

NOTE:
 THIS PLAT SUPERCEDES THE PLAT OF SUBDISTRICT NO. 19-1 TITLED SANDY HOOK WATER, DATED JULY 1988, DWG. NO. SD19-1-00, RECORDED IN PLAT FOLD 2339 AMONG THE PLAT OF RECORDS OF WASHINGTON COUNTY, MARYLAND.

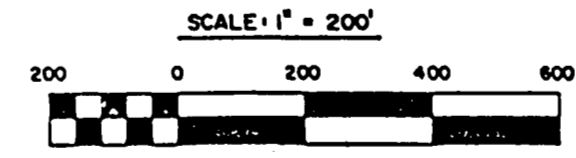

Filed and Recorded
 MAR 15 1990
[Signature]
 Clerk of Circuit Court

APPROVED BY:
 WASHINGTON COUNTY SANITARY DISTRICT
[Signature] 9/21/90 *[Signature]* 9/21/90
 CHAIRMAN DATE SECRETARY TREASURER DATE

APPROVED BY:
 BOARD OF COUNTY COMMISSIONERS OF WASHINGTON COUNTY
[Signature] *[Signature]* 10/20/90
 PRESIDENT CLERK DATE

BASE MAPS FURNISHED BY THE PROPERTY MAP DIVISION OF THE MARYLAND DEPARTMENT OF ASSESSMENTS AND TAXATION.

WASHINGTON COUNTY SANITARY DISTRICT WASHINGTON COUNTY, MD.			
REVISED PLAT OF SUBDISTRICT NO. 19-1 (WATER) SANDY HOOK			
DATE 7-16-90	DRAWN BY S.F.E.	PLAT NO. P-191-1000	SHEET NO. 1 OF 1

MSA CSU 2167-68